



Conversion set INEO UPDATE 05.187.00..0000

Conversion of big access opening to small access opening

Removal of the push plate (big access opening)



Removal of fill valve and flush valve



Removal of fill valve and flush valve



Installation of a new flush valve with cable box



Installation of fill valve and water inlet

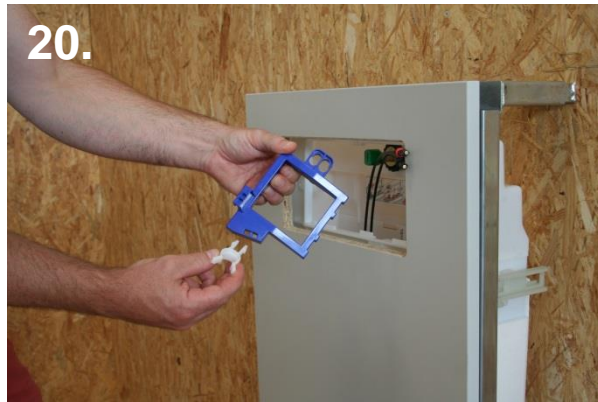

Installation of fill valve and water inlet



1. Mounting option: Application of a decorative plate

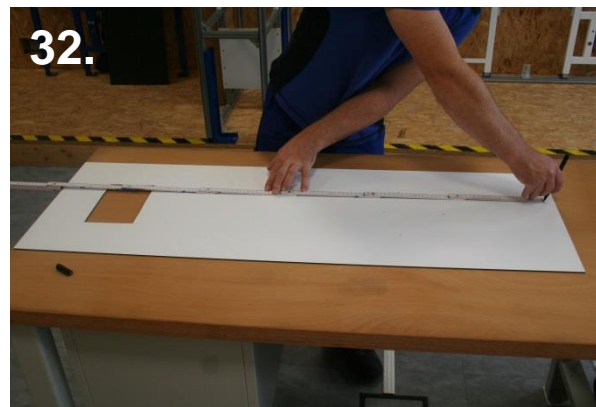

1. Mounting option: Application of a decorative plate

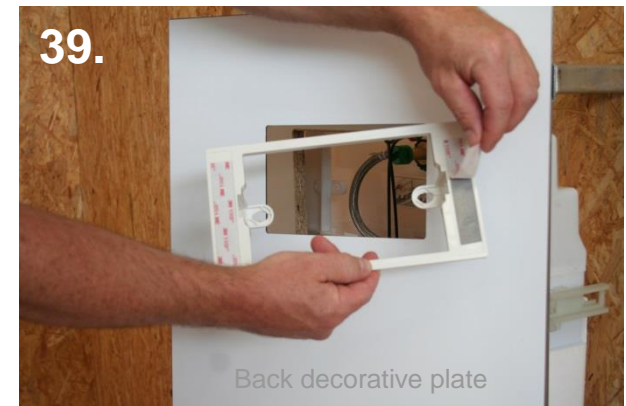
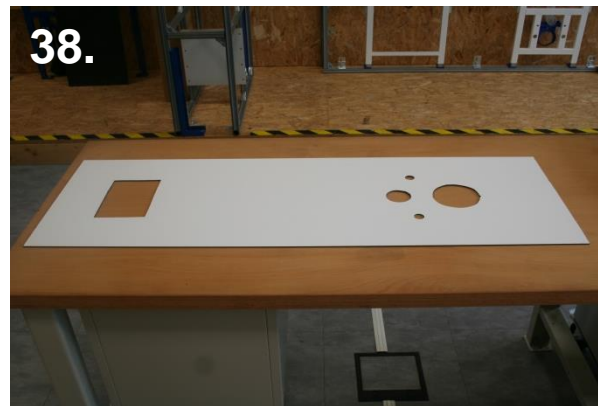
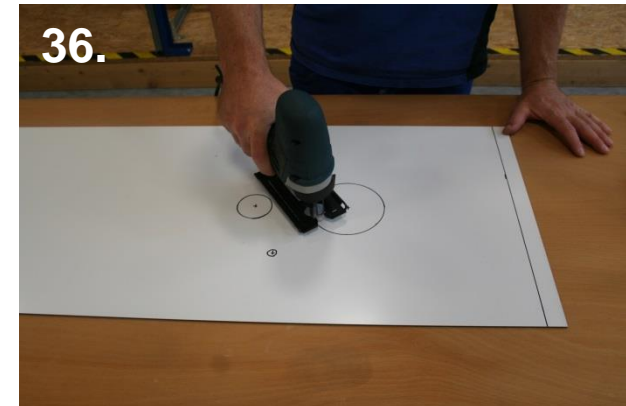
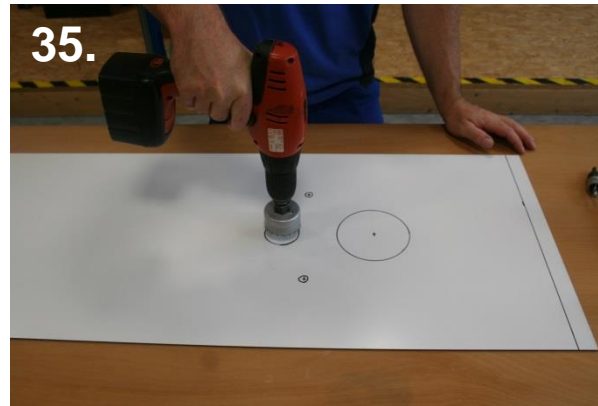
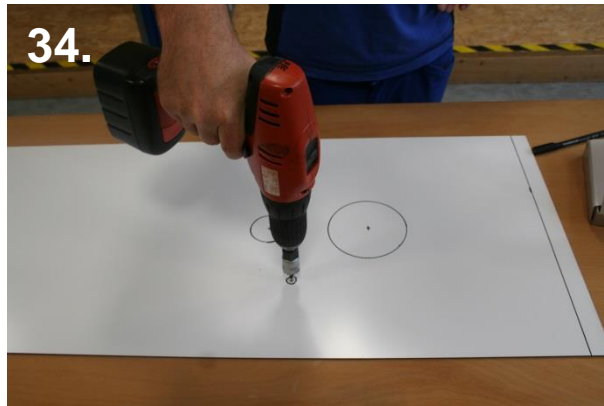

1. Mounting option: Application of a decorative plate



1. Mounting option: Application of a decorative plate



Installation of a flush-mounted push plate

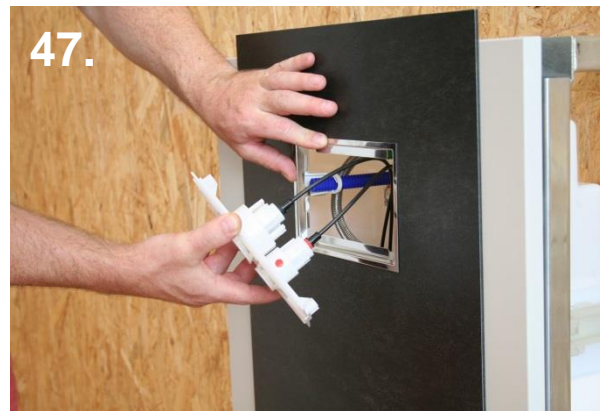

1. Mounting option: Application of a decorative plate



Installation of a flush-mounted push plate



2. Mounting option: Tiling set

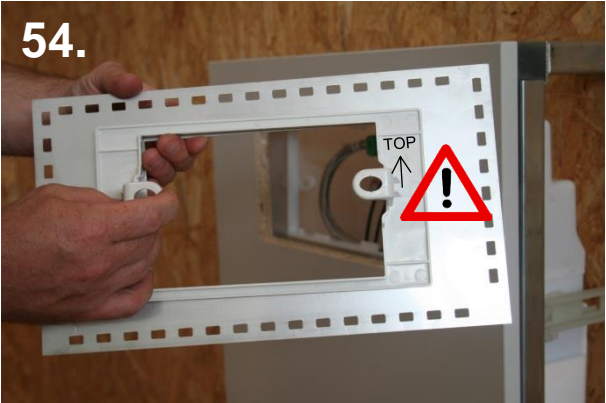
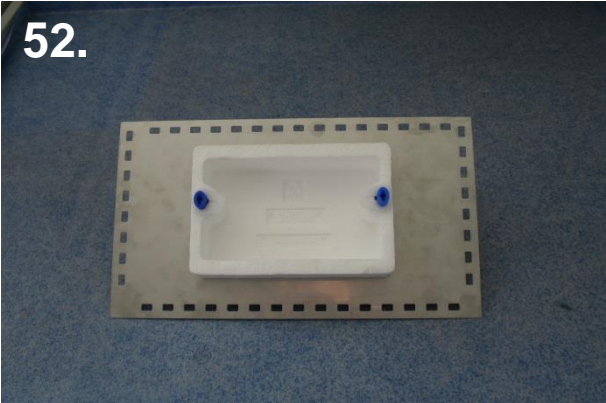

2. Mounting option: Tiling set

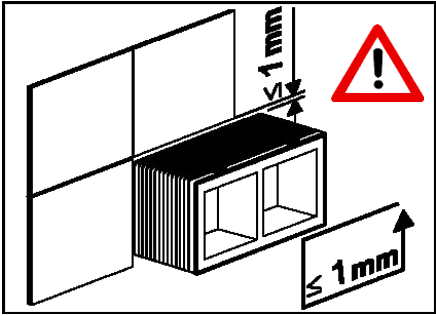
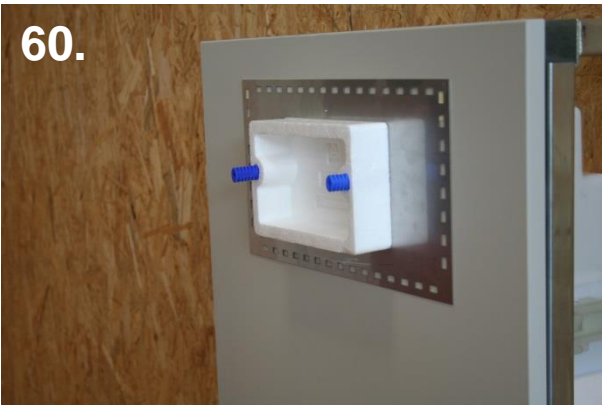

2. Mounting option: Tiling set



Installation of a flush-mounted push plate after tiling



2. Mounting option: Tiling set



Installation of a flush-mounted push plate after tiling

